

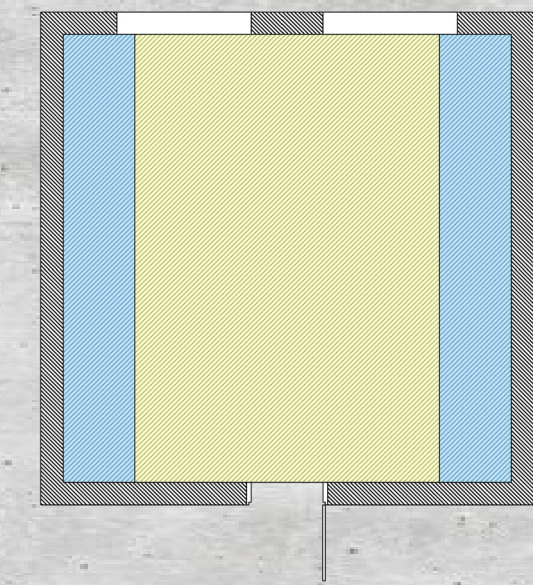

- LIST OF NEEDS:
- FULL EQUIPED KITCHEN
 - BATHROOM
 - WASHING MACHINE
 - CLOSET
 - TINY LIVING ROOM
 - BEDROOM
 - BOOKSHELVES
 - STORAGE SPACE
 - SHOE STORAGE
 - * NATURAL LIGHTING
 - * SPACES MUST BE DIVIDED BUT RELATED
 - * FREE CIRCULATION BETWEEN SPACES

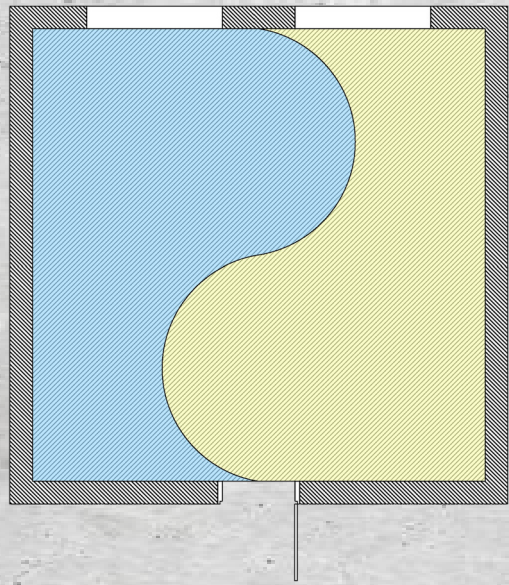

Leisure / rest services



Day zone Night zone

SPACE DIVISION

1. BEDROOM
2. TABLE
3. KITCHEN STORAGE
4. BOOKSHELVES
5. TINY LIVING ROOM
6. UPPER STORAGE
7. CLOSET
8. BATHROOM
9. KITCHEN
10. WASHING MACHINE / LAUNDRY CLOSET
11. SHOE STORAGE

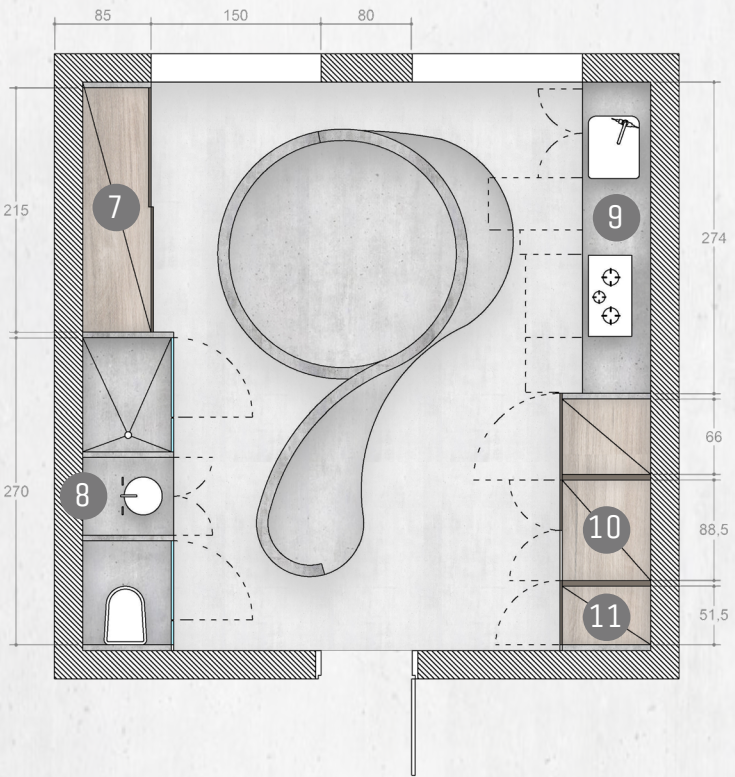
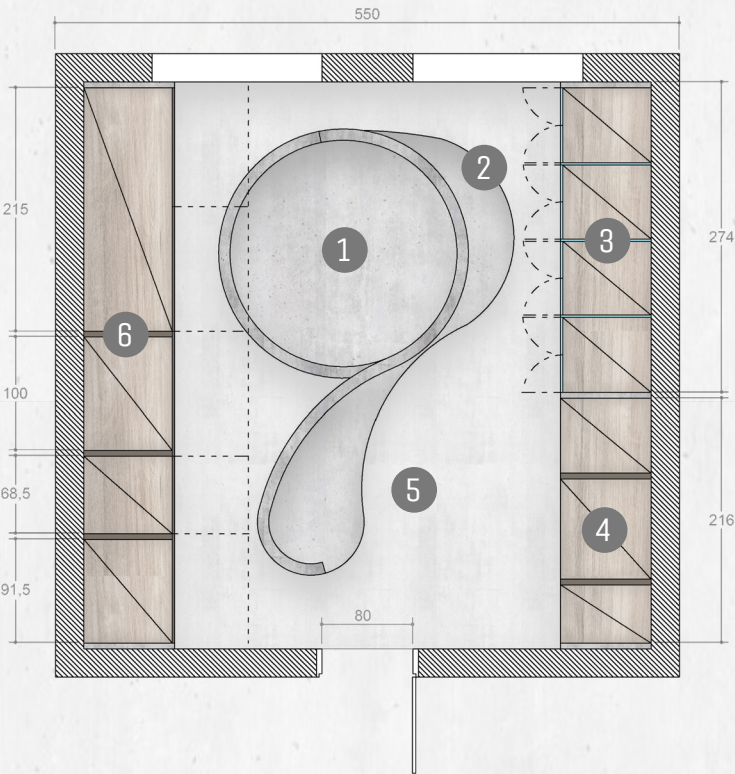

MATERIALS:



SMOOTH CONCRETE

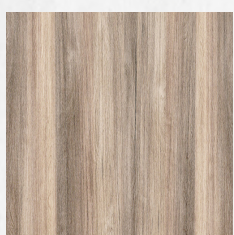

OAK WOOD

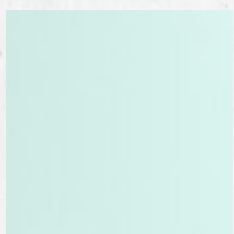

OPAQUE GLASS

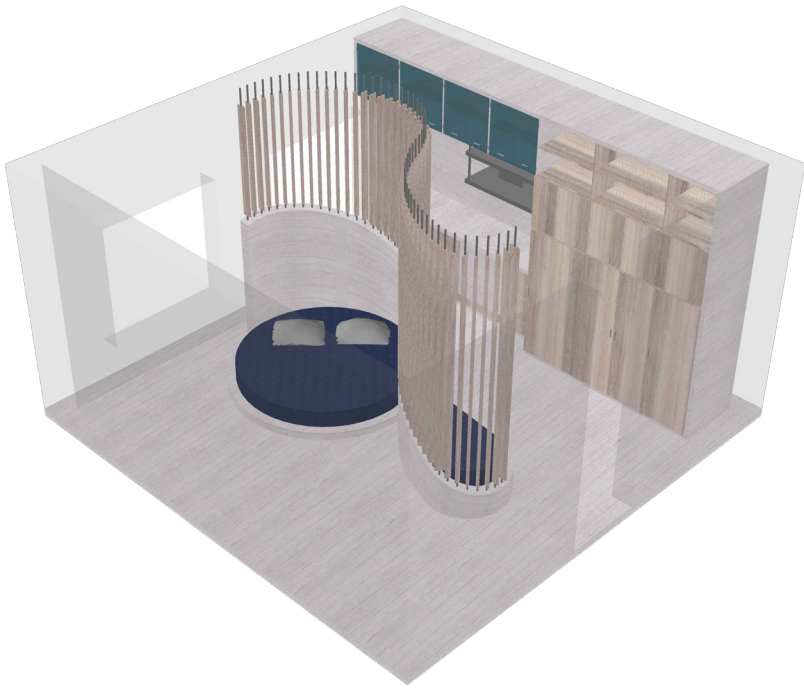
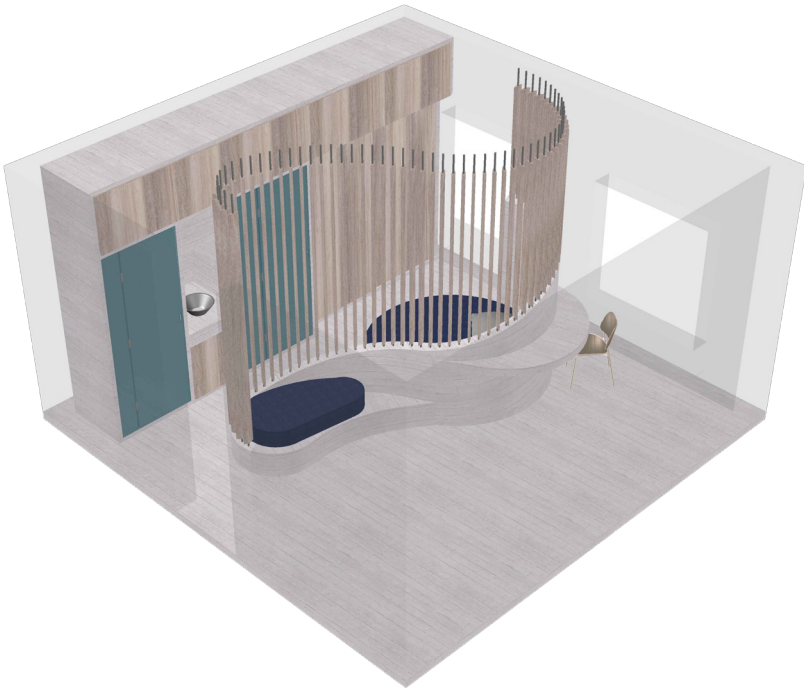

THE CENTRAL VOLUME ACTS AS A SPACE DIVIDER, BUT IT IS ALSO THE VOLUME THAT ALLOWS A FREE CIRCULATION ALL AROUND THE APARTMENT.

IN ORDER TO SATISFY THE NEED OF NATURAL LIGHTING, THERE ARE NO SOLID WALLS IN THE MIDDLE THAT MIGHT BLOCK THE SUN LIGHT COMING IN FROM THE TWO WINDOWS.

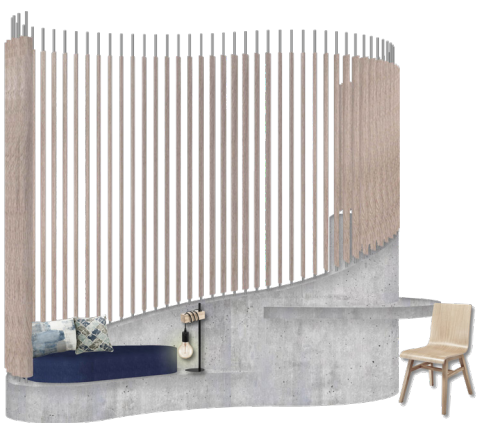
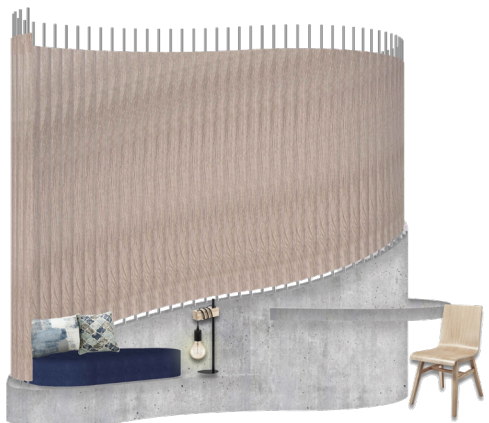
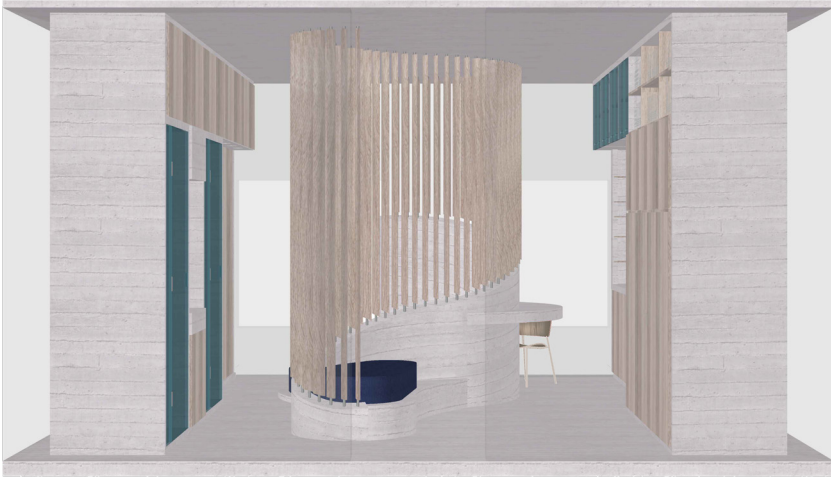

HOW THE PIVOTING WOODEN PILARS WORK
THE PIVOTING WOODEN PILARS CREATE A DYNAMIC ENVIRONMENT.

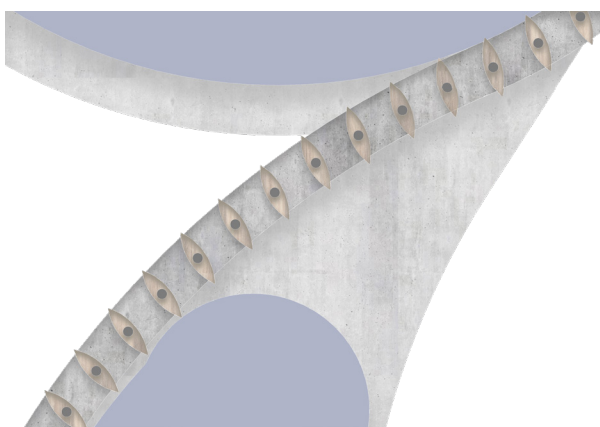
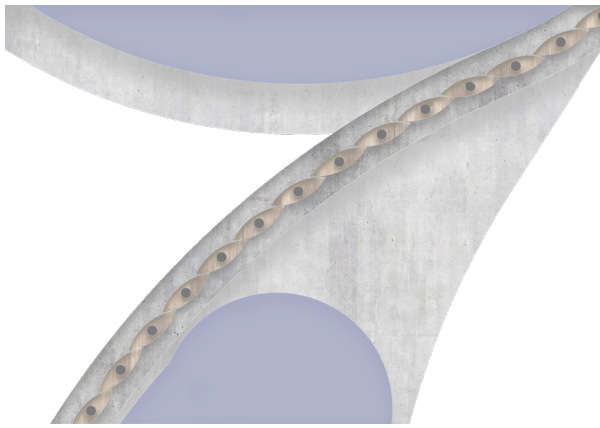
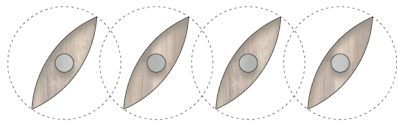
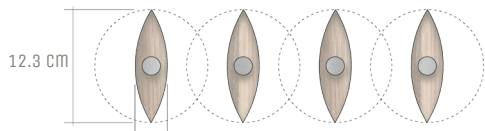
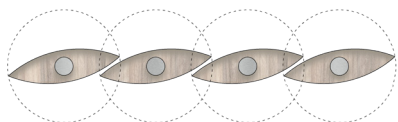

THE PIVOTING WOODEN PILARS ALLOW THE CENTRAL VOLUME TO ACT EITHER AS A DIVISION TO HAVE PRIVACY OR AS AN OPEN SPACE THAT LETS THE LIGHT IN.

